

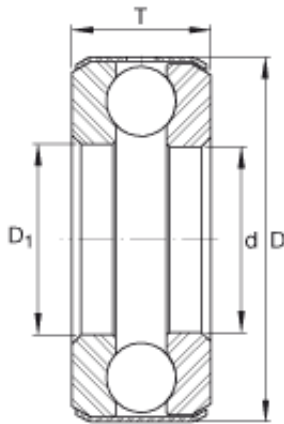

# LLC NTN-SNR RUS

## INA D39-1/2 thrust ball bearings



Bearing No. D39-1/2

Size	76.2x116.688x25.4 mm
Bore Diameter	76,2 mm
Outer Diameter	116,688 mm
Width	25,4 mm
d	3 inch
d	76,2 mm
D	4,594 inch
D	116,688 mm
T	1 inch
T	25,4 mm
D <sub>1</sub>	3,063 inch
m	2,05 lbs / Weight
m	928 g / Weight
C <sub>a</sub>	18200 lbf / Dynamic load rating (axial)
C <sub>a</sub>	81000 N / Dynamic load rating (axial)
C <sub>0a</sub>	51000 lbf / Static load rating (axial)
C <sub>0a</sub>	227000 N / Static load rating (axial)
Category	Thrust Ball Bearing
Inventory	0.0
Manufacturer Name	SCHAEFFLER GROUP
Minimum Buy Quantity	N/A
Weight / Kilogram	1.112
Product Group	B00308

D39-1/2 Bearing 2D drawings and 3D CAD models



## LLC NTN-SNR RUS

Rolling Element	Ball Bearing
Thrust Bearing	Yes
Single or Double Direction	Single Direction
Banded	Yes
Cage Material	Steel
Precision Class	ABEC 1   ISO P0
Component Description	Roller Assembly Plus Raceways
Other Features	Single Row
Long Description	3" Bore 1; 3-1/16" Bore 2; 4-19/32" Outside Diameter; 1" Height; Ball Bearing; Single Direction; Banded; Steel Cage; ABEC 1   ISO P0 Precision
Inch - Metric	Inch
Category	Thrust Ball Bearings
UNSPSC	31171552
Harmonized Tariff Code	8482.10.50.08
Noun	Bearing
Keyword String	Ball Thrust
Manufacturer URL	<a href="http://www.ina.com">http://www.ina.com</a>
Manufacturer Item Number	D39-1/2AKL
Weight / LBS	2.1
Bore 2	3.063 Inch   77.8 Millimeter
Outside Diameter	4.594 Inch   116.688 Millimeter
Bore 1	3 Inch   76.2 Millimeter
Height	1 Inch   25.4 Millimeter
Overall Height with Aligning Washer	0 Inch   0 Millimeter